

This map is based on Ordnance Survey material with the permission of Ordnance Survey on behalf of the Controller of Her Majesty's Stationery Office. © Crown copyright. Unauthorised reproduction infringes Crown copyright and may lead to prosecution or civil proceedings. Highways England 100018228, 2017.

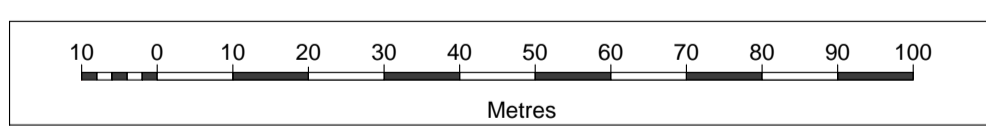

- Notes:**
- The legend is identical on all sheets of the Land Plans and therefore not all items detailed in the legend are represented on each sheet;
  - Land Parcel/Plot numbers are annotated in blue and are made up of a Sheet Number and then a unique plot number. These plot numbers correspond to those represented in the Book of Reference;
  - Land Parcel Number 29/1 is not used and does not appear on the plan.

- Legend:**
- Development Consent Order (DCO) boundary
  - Local Authority boundary
  - Land to be acquired – permanent title acquisition
  - Land to be used temporarily and rights to be acquired permanently
  - Land to be used temporarily
  - Land not subject to compulsory acquisition or temporary possession
  - Cut Line

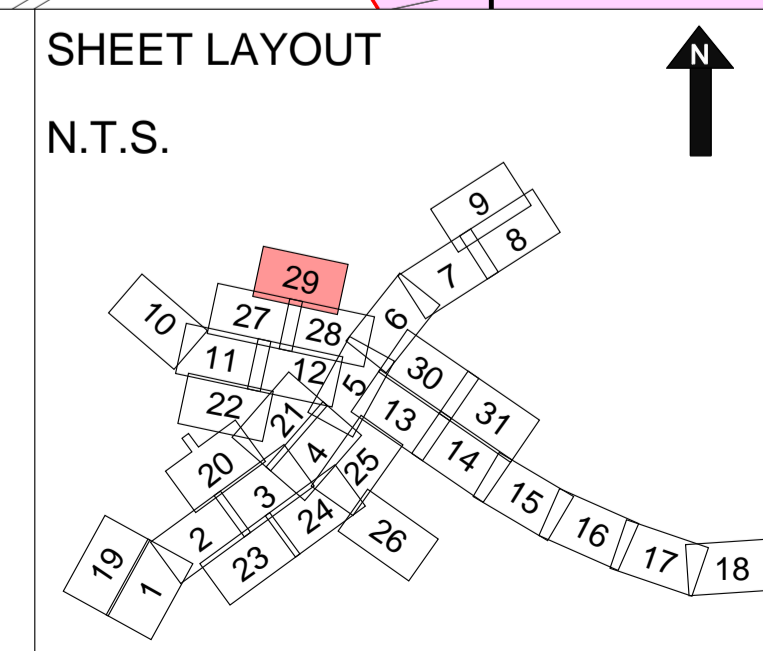

Description	Status	Revision	Draw	Checked	Reviewed	Authorised	Issue Date
DCO APPLICATION	Draft	12.0	LIR	NIR	AMU		04/06/2019

Drawing Suitability: **DCO APPLICATION** Status: **A4**

Created by:  
TerraQuest Solutions Limited  
Quayside Tower  
252-260 Broad Street  
Birmingham  
B1 2HF

w: [www.terraquest.co.uk](http://www.terraquest.co.uk)  
e: [info@terraquest.co.uk](mailto:info@terraquest.co.uk)

Client: **Working on behalf of**

Project Title: **M25 Junction10/A3 Wisley Interchange**

Drawing Title: **LAND PLANS REGULATION 5(2)(i) SHEET 29 OF 31**

Drawing Number: **TR010030/APP/2.2** Rev: **v12.0**

HE Pin: HE551522 Scale: 1:1,000 Original Size: A1