

# M6 junction 10 improvement work

## Weekend closure 24 - 27 September

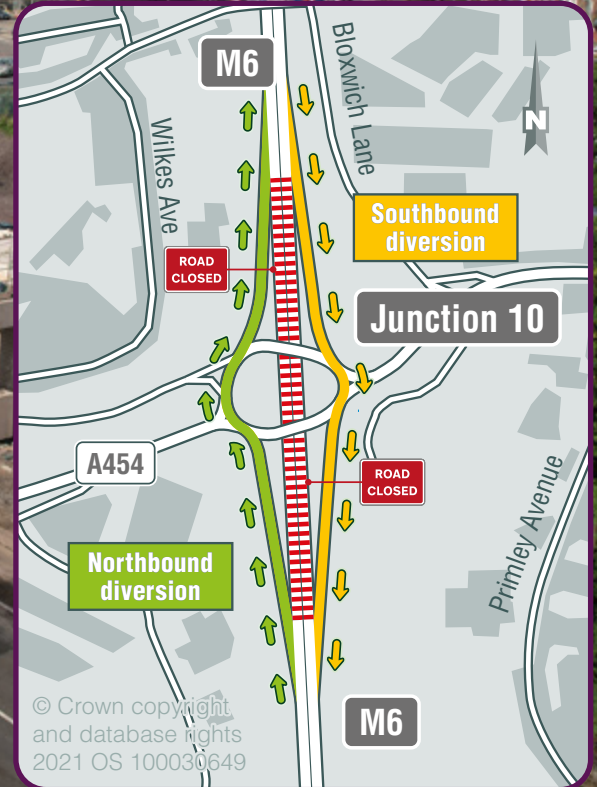

North bridge beam lift completed successfully

# Motorway closed - expect severe delays

We're closing the M6 at junction 10 between the exit and entry slip roads from 8pm Friday 24 September to 6am Monday 27 September.

Following these major works, we will be conducting a full closure of M6 junction 10 from 8pm Saturday 9 October to 6am Monday 11 October to start the bridge deck installation. Both closures will use the same diversion routes.

## Why

We're improving M6 junction 10 by building new, wider bridges across it. We need to close the M6, so we can safely lift large bridge beams into place. We successfully completed the north side in August and are now doing the same on the south side.

## Our advice

The local roads will be significantly busier, please avoid the area if possible. If you need to make a local journey, consider using public transport wherever possible, or walking or cycling for shorter trips. For information on public transport, visit: [www.wmnetwork.co.uk/plan-your-journey/major-roadworks-and-events/m6-j10/](http://www.wmnetwork.co.uk/plan-your-journey/major-roadworks-and-events/m6-j10/)

**Please plan and allow extra time for your journeys.**



Please recycle me