

# Memo

<b>To:</b>	RM		
<b>From:</b>	MT	<b>Email:</b>	Redacted
<b>Phone:</b>	-	<b>Date:</b>	09 September 2019
<b>Ref:</b>	HE543917-ATK-LHA-LN-ZL-000071 C01	<b>cc:</b>	EB / SW
<b>Subject:</b>	A2BE - Proposed Modification (MOD-04) - Removal of CPO Plots 2/9a, 2/10a & 2/11a - Impact on Published Orders		

## 1. Removal of CPO Plots 2/9a, 2/10a & 2/11a Modification (MOD-04)

In summary, a modification is proposed to the published preliminary design (included within the February 2019 published Orders) to remove the requirement to access and alter any of the existing drainage works within Springhead Nurseries car park area or utilise their existing access road from the A2 eastbound carriageway.

Three CPO Plots (2/9a, 2/10a & 2/11a) were included within the Made Compulsory Purchase Order to facilitate access with or without vehicles, plant and machinery for all purposes connected with the connection to, maintenance of and operation of a 1200 mm diameter pipe, pollution control chamber with associated manholes and equipment.

Following a review of the proposed drainage design and further to additional investigations into existing rights associated with the existing drainage manholes, drainage runs and access arrangements within the vicinity it has been determined that no access rights or works would be required over and above those already in existence.

## 2. Amendments to the Side Roads Order (SRO)

No alterations to the highway alignment are required for this proposal, therefore no modifications will be required to the Side Roads Order.

## 3. Amendments to the Line Order (MLO)

No alterations to the highway alignment are required for this proposal, therefore no modifications will be required to the Line Order.

## 4. Amendments to the Compulsory Purchase Order (CPO)

Plots 2/9a, 2/10a and 2/11a will be removed from the CPO. Figures 1 & 2 overleaf identify Plots 2/9a, 2/10a and 2/11a on CPO Sheet 2 (Figure 1) and the same area with the Plots removed (Figure 2).

Amendments will also be required to the CPO Schedule to identify the Plots removed. It is not proposed to add any new plots in respect of those removed.

## 5. How the Amendments should be incorporated

The CPO has been published as a Made Order (signed, sealed and dated). The modifications will therefore be put to the Inspector to modify the Made CPO prior to confirmation by the Secretary of State for Transport. The intention to remove these Plots has been communicated to the relevant land owners.

## 6. Summary

Due to the proposed change, modifications to the Compulsory Purchase Order would be required by the Secretary of State for Transport to remove Plots 2/9a, 2/10a and 2/11a prior to confirmation. However, no modifications would be required to the Side Roads Order or Line Order.

Highways England intends to ask the Inspector to recommend that the Compulsory Purchase Order be confirmed with the modifications described in this note.

# Memo

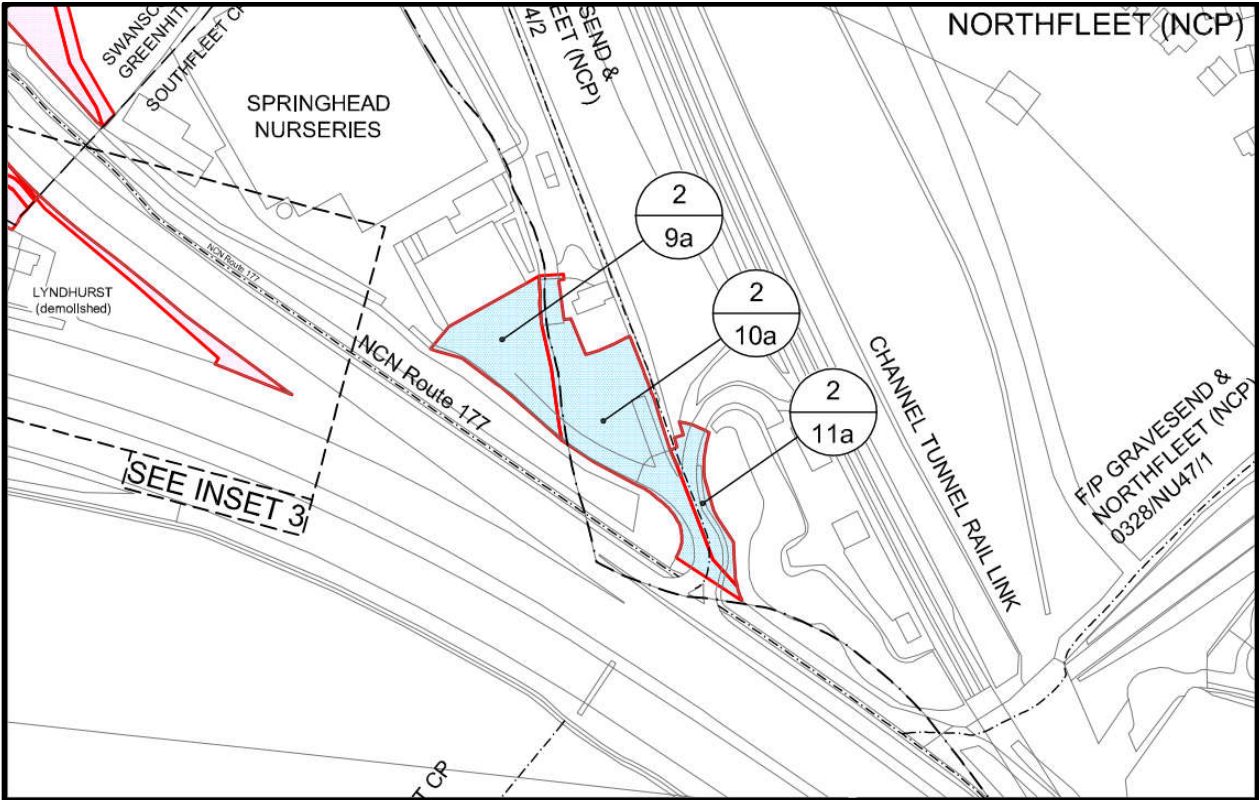

Figure 1. Published Made Compulsory Purchase Order – Sheet 2 extract

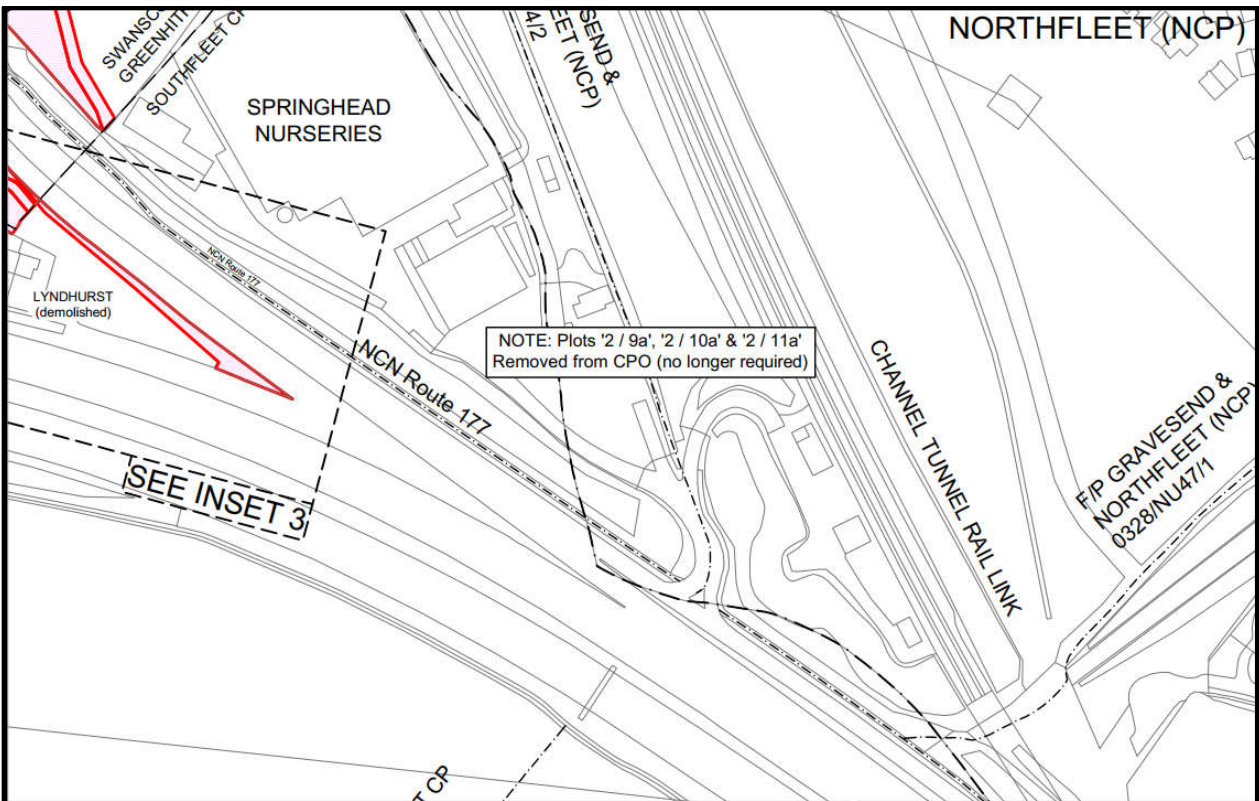

Figure 2. Revised Compulsory Purchase Order – Sheet 2 extract